

# HELMET WITH RACHET, CHIN STRAP & NYLON SUSPENSION.

ARTICLE # A5-18-24



EN 397:2012



**FEATURES:**  
EN 397:2012 Tested & Passed.  
HDPE (High Density Poly Ethylene) shell.  
Ratchet suspension quick action ratchet wheel.  
1-Touch nylon suspension system that works as a shock absorber.  
Universal slot for ear muff.  
6 point ventilation to support air flow.  
Sweat band made with soft absorbent material and soft cushion.  
Peak and sides designed to support rain/water drainage.  
Chin strap with large cup and nylon webbing for added security for working at height.

**APPLICATIONS:**  
Impact resistance from objects falling from height by resisting the impact and deflecting the blow to the head.  
Resist penetration of sharp objects.  
Absorbs the shock of a blow.  
Water resistant.

Size: Universal.

G.Weight/N.Weight: 11.86kgs/10.60kgs/Crtn

Carton dimension: 57.50x46.50x41.00cm

Cubic meter/Carton: 0.1096

Packing: 30pcs/Crtn



Article #: A130680820  
Chin Strap  
Cup Shaped  
Adjustable Chin Strap



Article #: A106350511  
RATCHET SUSPENSION  
TEXTILE FITTING FOR  
AMERIZA HELMETS, 4 Points, Ratchet  
Type Textile Suspension With Foam Sweat Band.



HELMET - White  
A518240820



HELMET - Yellow  
A518240920



HELMET - Blue  
A518240320



HELMET - Red  
: A518241220



HELMET - Orange  
A518240620



HELMET - Green  
A51821020



HELMET - Grey  
A518240720

# HELMET WITH RACHET, CHIN STRAP & NYLON SUSPENSION.

ARTICLE # A5-18-24



## Standards:

CE EN 397: 2012, Test Report # POCE16052001PRS.

## Assembly Instructions – Suspension Installation

All AMERIZA Hard Hats are shipped with suspension uninstalled to prevent distortion during shipping. The suspension must be correctly installed according to the instructions and must be adjusted to a snug fit in order to provide maximum protection. Turn hard hat shell upside down on its crown.

1. Place the suspension in the hard hat with the brow pad towards the front brim of the hard hat (Figure 1).
2. Fold one suspension key out and up (Figure 2).
3. Slide suspension key into slot as shown and press key fully into slot (Figures 3 and 4) – repeat for other three suspension keys.
4. Note that suspension webbing may be tight initially upon installation of the keys – push down at the center cross with your fist to ensure all clips are secured and webbing is ready to be worn (Figure 5).
5. Completed assembly (Figure 6).

## Inspection:

- Before and after each use, inspect the helmet for wear and damage:

## Shell

- Inspect the helmet for breakage, cracks, craze patterns, discoloration, chalky appearance, or any other unusual condition.
- Do not use the helmet if the shell displays any of these conditions. Any of the above conditions can indicate that the helmet has lost its capacity to protect from impact, penetration and/or electrical shock.

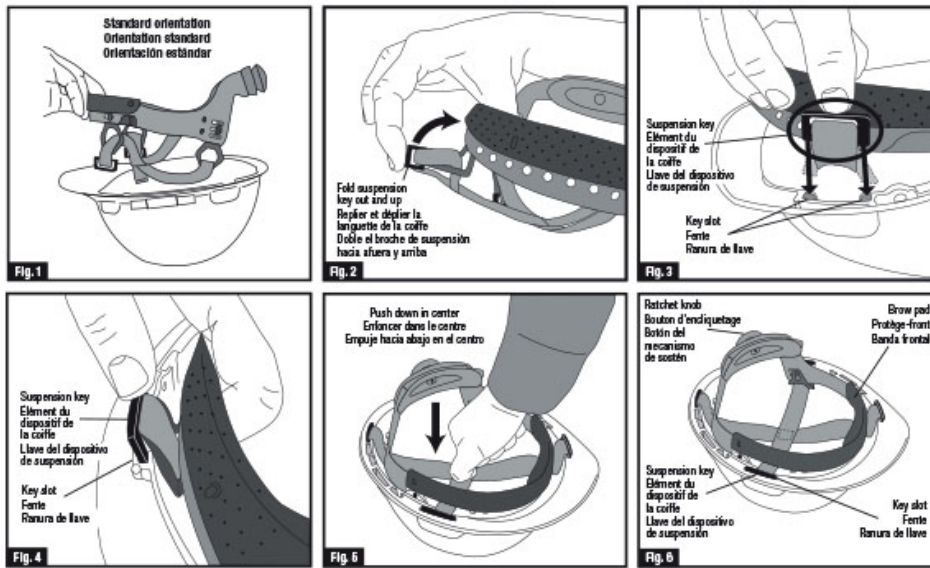

## **HELMET WITH RACHET, CHIN STRAP & NYLON SUSPENSION.**

ARTICLE # A5-18-24



### **Suspension**

- Check the suspension for loss of flexibility.
- Check the suspension for cracks, breaks, frayed straps, or damaged stitching.
- If any of these conditions are found, replace the suspension before wearing the helmet.

### **Helmet care**

- Clean the helmet assembly regularly with mild soap (no detergents) and warm water.
- Helmets must be cleaned regularly so they can be adequately inspected. A clean suspension also helps to avoid skin irritation.
- Do not throw, drop or use helmet as a support. Like any piece of specialized equipment this helmet must not be abused.
- Store helmet in a clean and dry environment.

### **Useful service life guidelines**

This helmet is made from high quality material but it is not meant to last forever.

- Inspect the helmet regularly and replace it or any part necessary. Never take a chance with your safety.
- Suspension – Replace after no more than 12 months of use.
- Entire helmet – Replace after no more than 12 months of use. 5 years is the maximum shelf life of the helmet. If you notice wear or damage during a regular inspection, replace the helmet or suspension immediately, no matter how long it has been used.
- Always replace the entire helmet after it has withstood an impact or penetration.

### **Warning**

Failure to follow these warnings can result in serious personal injury or death.

- This helmet provides a limited impact and penetration protection to the top of the head.
- This helmet is not specifically designed to protect against impact or penetration from front, side or rear (that is, "lateral"). This helmet must fit securely on the head to provide maximum protection.
- Never store gloves, cigarettes, earplugs etc. between the suspension and the shell, objects in this space can transmit large force to the head and neck, resulting in serious injury or death.
- Never use this helmet as a vehicular or sports helmet.
- Inspect the helmet before and after each use. Replace any part showing wear or damage.
- Never exceed the useful service life guidelines of helmet as outlined in these instructions. Replace components or helmets as required.
- Never alter or modify this helmet in any way.
- Never use paints, solvents or hydrocarbon type cleaners (i.e. MEK, Thinner, gasoline, kerosene) on this helmet. These may cause unnoticeable damages.